

# Pinces

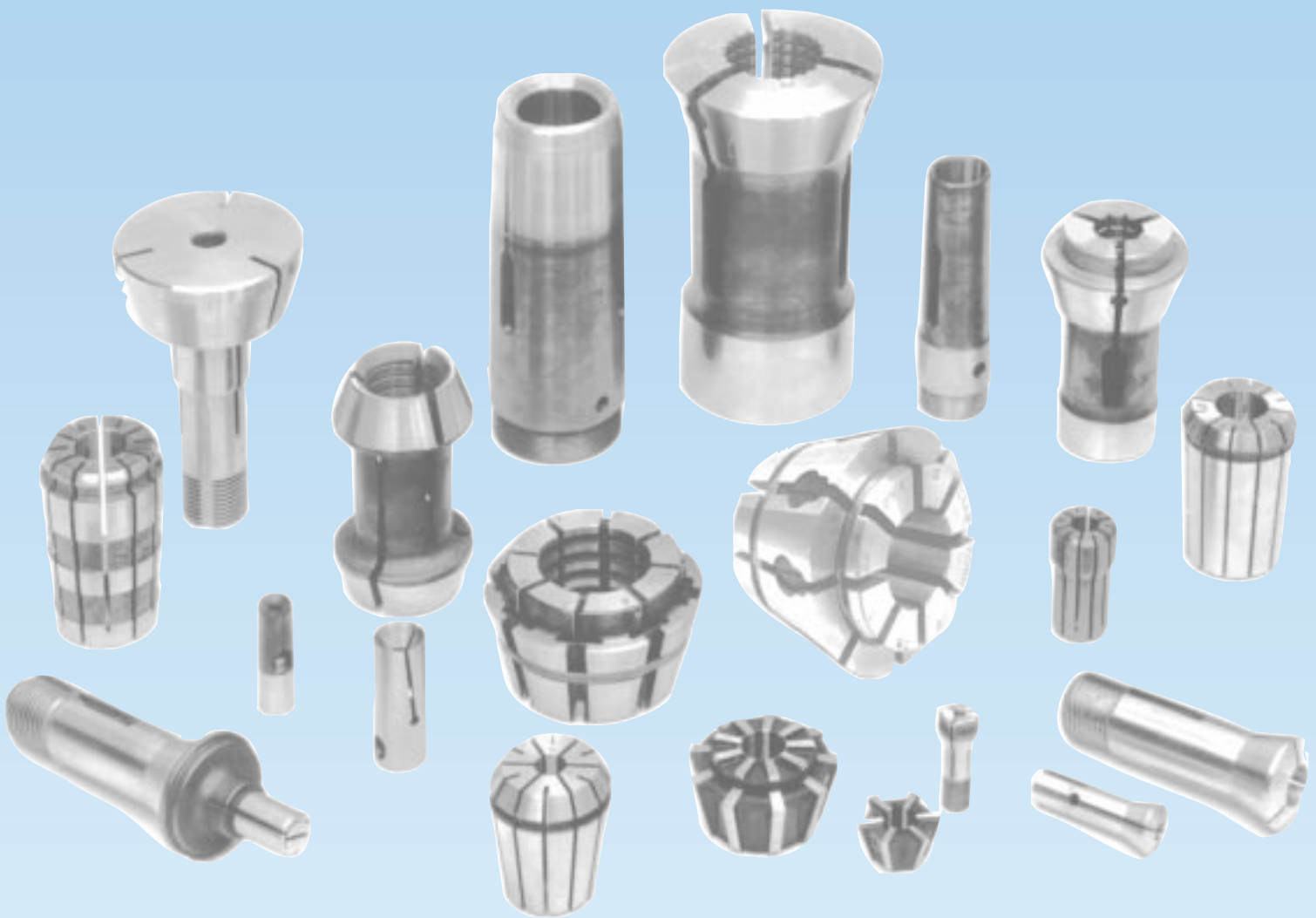

**CHATEL  
GALLAY**

## PINCES DE SERRAGE POUSSEES



**Type F**

page 1  
page 2  
page 3

## PINCES D'AVANCE



**Type A**

page 4

## PINCES DE SERRAGE TIREES



**Type W**

page 5

## PINCES DE SERRAGE TIREES



**Type B**

page 6

## PINCES DE SERRAGE TIREES



**Type P**

page 6

## PINCES DE SERRAGE D'OUTILS



**Type ER**

page 7

## PINCES DE SERRAGE D'OUTILS



**Type  
Double Angle**

page 8

## PINCES DE SERRAGE TIREES



**Type W  
Pour Têtes  
Multibroches**

page 9

## PINCES DE SERRAGE MULTIBORE



page 10

## PINCES DE SERRAGE AUTO MULTIBORE



page 11

## PINCES DOUBLE CONE



**Type C**

page 12

**TASSEAUX  
EBAUCHES**



**TASSEAUX  
EXPANSIBLES**

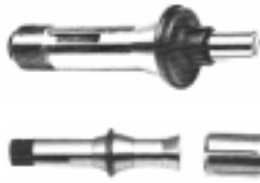

**Monobloc  
A douille**

**PINCES  
ENTONNOIRS**



**PINCES DE SERRAGE  
D'OUTILS**



**Type D**

**ACCESSOIRES  
POUR RAVITAILLEURS**

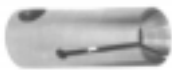

**PINCES  
RUBBER FLEX**



**PINCES  
PICK UP**



**PINCES  
SPECIALES**



**Nous consulter**

**BUTEE A  
BILLE**



**SYLICON**



**SPRAY**



## Type d'alésage & Position des fentes



Rond



6 pans

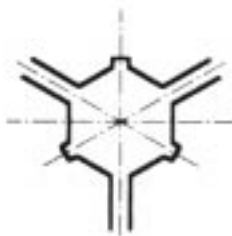

Carré

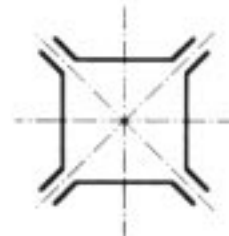

## Forme d'alésage



Alésage rainuré



Alésage quadrillé



Alésage lisse

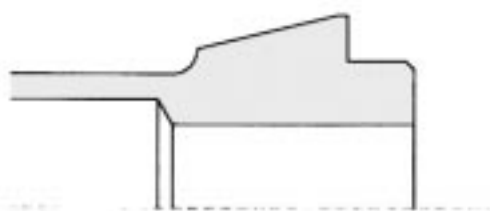

# Pinces de serrage poussées



Série 1

Type F

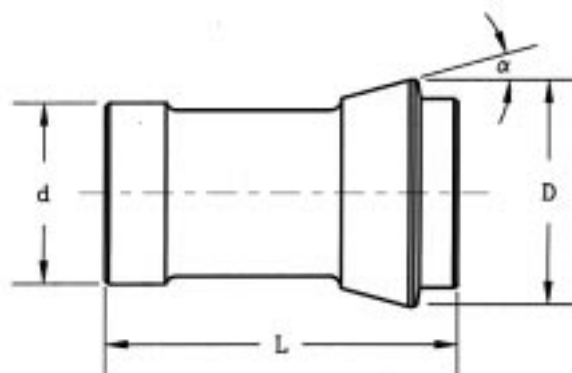

Référence	d	D	L	Cône α	Alésages		
					de - à ( mm )		par ( mm )
1008 E	4.5	6.75	17.25	15°	0.5 - 0.9	rond	0.1
					1.0 - 2.9	rond	0.1
					3.0	rond	.
1020 E	7	10.5	26	15°	1.0 - 1.9	rond	0.1
					2.0 - 2.9	rond	0.1
					3.0 - 5.5	rond	0.5
					3.1 - 5.4	rond	0.1
101 E	8	12	42	16°	0.5 - 0.9	rond	0.1
					1.0 - 2.9	rond	0.1
					3.0 - 6.0	rond	0.1
109 E	10	15.5	47.5	20°	0.5 - 0.9	rond	0.1
					1.0 - 2.9	rond	0.1
					3.0 - 7.0	rond	0.1
					4.0 - 6.0	6&4pans	1.0
					4.5 - 5.5	6&4pans	1.0
					2.0 - 3.0	6&4pans	1.0
1155 E	12	18.1	44.5	15°	1.0 - 2.9	rond	0.1
					3.0 - 3.9	rond	0.1
					4.0 - 10.0	rond	0.5
					4.1 - 9.9	rond	0.1
117 E	14	18	46	13°	0.5 - 0.9	rond	0.1
					1.0 - 1.9	rond	0.1
					2.0 - 2.9	rond	0.1
					3.0 - 10.0	rond	0.1
					10.1 - 11.5	rond	0.1
					4.0 - 6.0	6&4pans	1.0
					7.0 - 9.0	6&4pans	1.0
					4.5 - 7.5	6&4pans	1.0
120 E	15	21	64	16°	1.0 - 1.9	rond	0.1
					2.0 - 2.9	rond	0.1
					3.0 - 12.0	rond	0.1
					4.0 - 6.0	4 pans	1.0
					4.0 - 8.0	6 pans	1.0
					4.5 - 6.5	6&4pans	1.0
123 E	16	22	55	15°	2.0 - 2.5	rond	0.5
					3.0 - 13.0	rond	0.5
					3.1 - 9.9	rond	0.1
					4.0 - 10.0	6&4pans	1.0
					4.5 - 6.5	6&4pans	1.0

# Pinces de serrage poussées



Série 1

Type F

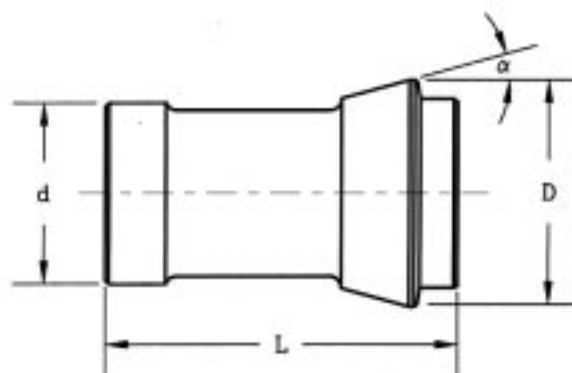

Référence	d	D	L	Cône α	Alésages		
					de - à (mm)		par (mm)
1299 E	20	27.5	60	15°	4.0 - 16.0	rond	1.0
					7.0 - 14.0	6&4pans	1.0
136 E	20	26	54	15°	1.0	rond	.
					1.5 - 2.5	rond	0.5
					3.0 - 16.0	rond	0.5
					7.0 - 14.0	6&4pans	1.0
138 E	20	28	67	16°	2.0 - 2.5	rond	0.5
					3.0 - 16.0	rond	0.5
					5.0 - 14.0	6&4pans	1.0
140 E	22	30	55	15°	1.5 - 2.5	rond	0.5
					3.0 - 16.0	rond	0.5
					7.0 - 14.0	6 pans	1.0
					7.0 - 10.0	4 pans	1.0
1341 E	23	31	47	15°	3.0 - 20.0	rond	1.0
144 E	25	34	65	15°	6.0 - 20.0	rond	0.5
					8.0 - 17.0	6 pans	1.0
					8.0 - 14.0	4 pans	1.0
145 E	25	35	77	16°	3.0 - 20.0	rond	0.5
					8.0 - 14.0	6 pans	1.0
					8.0 - 14.0	4 pans	1.0
146 E	26	32	67	13°	5.0 - 20.0	rond	0.5
					8.0 - 17.0	6 pans	1.0
					8.0 - 14.0	4 pans	1.0
147 E	27	38	72.7	15°	1.0 - 1.5	rond	0.5
					2.0 - 2.5	rond	0.5
					3.0 - 23.0	rond	0.5
					7.0 - 19.0	6 pans	1.0
					7.0 - 16.0	4 pans	1.0
148 E	28	38	70	15°	2.0 - 2.5	rond	0.5
					3.0 - 24.0	rond	0.5
					7.0 - 19.0	6 pans	1.0
					7.0 - 14.0	4 pans	1.0
1446 E	30	38	65	15°	3.0 - 25.0	rond	0.5
					7.0 - 21.0	6&4pans	1.0
157 E	30	42	80	16°	3.0 - 25.0	rond	0.5
					7.0 - 22.0	6 pans	1.0
					7.0 - 14.0	4 pans	1.0

# Pinces de serrage poussées



Série 1

Type F

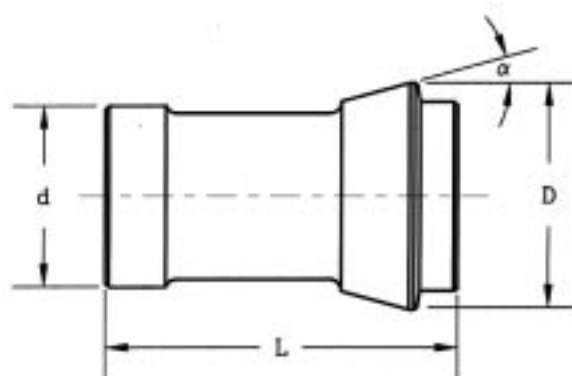

Référence	d	D	L	Cône α	Alésages		
					de - à ( mm )		par ( mm )
161 E	32	45	75	15°	3.0 - 26.0	rond	0.5
					7.0 - 22.0	6 pans	1.0
					7.0 - 14.0	4 pans	1.0
163 E	35	48	80	15°	2.0 - 2.5	rond	0.5
					3.0 - 30.0	rond	0.5
					7.0 - 27.0	6 pans	1.0
					7.0 - 14.0	4 pans	1.0
1536 E	37	47	92	16°	4.0 - 32.0	rond	0.5
					10.0 - 26.0	6 pans	1.0
164 E	38.1	49	107.5	15°	3.0 - 32.0	rond	0.5
					6.0 - 27.0	6 pans	1.0
					6.0 - 22.0	4 pans	1.0
173 E	48	60	94	15°	3.0 - 42.0	rond	0.5
					7.0 - 27.0	6 pans	1.0
					28.0 - 36.0	6 pans	1.0
					10.0 - 22.0	4 pans	1.0
					23.0 - 28.0	4 pans	1.0
185 E	66	84	110	15°	4.0 - 60.0	rond	1.0
					8.0 - 27.0	6 pans	1.0
					28.0 - 36.0	6 pans	1.0
					37.0 - 50.0	6 pans	1.0
					51.0 - 52.0	6 pans	1.0
					7.0 - 22.0	4 pans	1.0
					23.0 - 28.0	4 pans	1.0
					29.0 - 42.0	4 pans	1.0
1791 E	68	84	109	15°	25.0 - 61.0	rond	1.0
					20.0 - 32.0	6 pans	1.0
					33.0 - 40.0	6 pans	1.0
					41.0 - 50.0	6 pans	1.0
					51.0 - 52.0	6 pans	1.0
					20.0 - 32.0	4 pans	1.0
					33.0 - 40.0	4 pans	1.0
					41.0 - 42.0	4 pans	1.0

# Pinces d'avance

Série 2

Type A

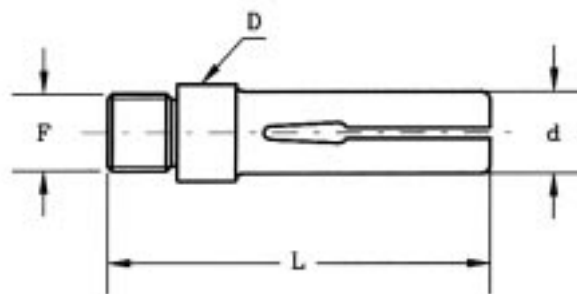

Référence	D	L	d	F	Alésages		
					de - à ( mm )		par ( mm )
207 E	18	70	16	M16 x 1 G	3.0 - 12.0	rond	0.5
					7.0 - 11.0	6 pans	1.0
					7.0 - 9.0	4 pans	1.0
2251 E	23	85	22	M22 x 1 G	3.0 - 18.0	rond	0.5
					7.0 - 16.0	6 pans	1.0
					7.0 - 14.0	4 pans	1.0
220 E	24	85	22	M22 x 1 G	3.0 - 18.0	rond	0.5
					7.0 - 16.0	6 pans	1.0
					7.0 - 12.0	4 pans	1.0
236 E	30	95	29	M28 x 1 G	3.0 - 24.0	rond	0.5
					7.0 - 19.0	6 pans	1.0
					7.0 - 16.0	4 pans	1.0
238 E	32.4	154	30	30.2 x 20 f' G 55°	12.0 - 25.0	rond	1.0
					10.0 - 22.0	6 pans	1.0
					10.0 - 17.0	4 pans	1.0
254 E	42	116	40	M40 x 1 G	4.0 - 36.0	rond	0.5
					10.0 - 27.0	6 pans	1.0
					28.0 - 30.0	6 pans	1.0
					10.0 - 22.0	4 pans	1.0
273 E	60	140	58	M58 x 1 G	10.0 - 52.0	rond	1.0
					24.0 - 27.0	6 pans	1.0
					28.0 - 36.0	6 pans	1.0
					37.0	6 pans	.
2775 E	62	140	61	M60 x 1 G	20.0 - 52.0	rond	1.0
					20.0 - 25.0	6 pans	1.0
					26.0 - 40.0	6 pans	1.0
					41.0 - 46.0	6 pans	1.0



# Pinces de serrage tirées



Série 3

Type W

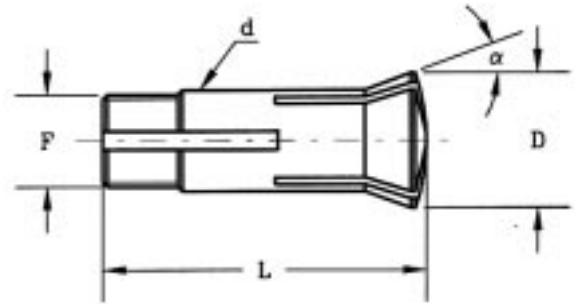

Référence	d	D	L	Cône $\alpha$	F	Alésages		
						de - à (mm)		par (mm)
314 E	10	14	43.6	15°	S 10 x 0.833 45°/5°	1.0 - 2.9	rond	0.1
						3.0 - 3.9	rond	0.1
						4.0 - 8.0	rond	0.5
						4.1 - 10.0	rond	0.1
318 E	12	16	46	15°	S 11.75 x 1.25 45°/5°	0.5 - 0.9	rond	0.1
						1.0 - 2.9	rond	0.1
						3.0 - 12.0	rond	0.5
						3.1 - 11.9	rond	0.1
						4.0 - 9.0	6 pans	1.0
						5.0 - 8.0	4 pans	1.0
3213 E	15	20.2	58.3	15°	S 14.75 x 1.25 45°/5°	1.0 - 2.5	rond	0.5
						3.0 - 12.0	rond	0.5
349 E	20	26.3	73	15°	S 19.7 x 1.666 45°/5°	0.5	rond	-
						0.6 - 0.9	rond	0.1
						1.0 - 2.5	rond	0.5
						1.1 - 2.9	rond	0.1
						3.0 - 20.0	rond	0.5
						3.1 - 19.9	rond	0.1
						4.0 - 16.0	6 pans	1.0
						4.0 - 14.0	4 pans	1.0
364 E	25	33.7	97.6	15°	S 24.7 x 15 f' 45°/5°	0.5	rond	-
						1.0 - 2.5	rond	0.5
						3.0 - 25.0	rond	0.5
						4.0 - 20.0	6 pans	1.0
						4.0 - 16.0	4 pans	1.0
385 E	31.75	37.5	83.4	10°	31.47 x 20 f d	1.0	rond	-
						1.5 - 2.5	rond	0.5
						3.0 - 27.0	rond	1.0
						6.0 - 23.0	6 pans	1.0
3881 E	48	57.5	110	10°	47.6 x 1.75	10.0 - 40.0	rond	1.0

# Pinces de serrage tirées

Série 3

Type B

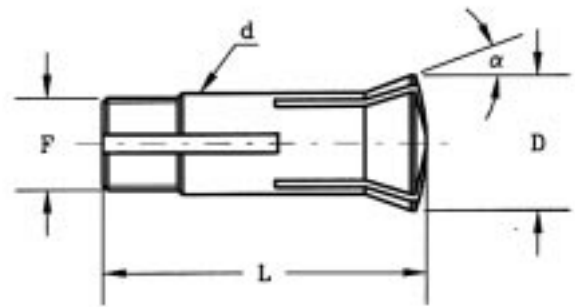

Référence	d	D	L	Cône α	F	Alésages		
						de - à (mm)		par (mm)
304 E	6	10.5	31	20°	W 5 x 36 f'	0.5 - 0.9	rond	0.1
						1.0 - 1.9	rond	0.1
						2.0 - 2.9	rond	0.1
						3.0 - 6.0	rond	0.5
302 E	8	13	35.5	20°	W 6.82 x 0.625	0.5 - 0.9	rond	0.1
						1.0 - 1.9	rond	0.1
						2.0 - 2.9	rond	0.1
						3.0 - 8.0	rond	0.5
324 E	15	21	55	20°	M 13 x 1	2.0 - 2.5	rond	0.5
						3.0 - 12.0	rond	0.5
						2.1 - 9.9	rond	0.1
						12.5 - 15.0	rond	0.5
363 E	25	33.5	89	16°	M 23 x 1	0.5 - 1.0	rond	0.5
						1.5 - 2.5	rond	0.5
						3.0 - 22.0	rond	0.5
3713 E	32	40	106	15°		1.0 - 1.5	rond	0.5
						2.0 - 2.5	rond	0.5
						3.0 - 30.0	rond	0.5

Type P

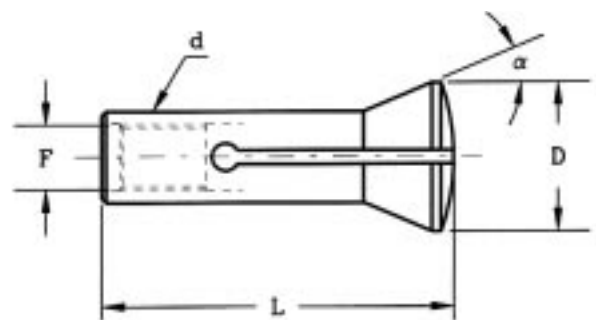

Référence	d	D	L	Cône α	F	Alésages		
						de - à (mm)		par (mm)
3023 E	6	8.5	27	15°	M 4	0.5 - 0.9	rond	0.1
						1.0 - 1.9	rond	0.1
						2.0 - 2.9	rond	0.1
						3.0 - 5.0	rond	0.5
3105 E	10	14	39	15°	M 7	1.0 - 1.9	rond	0.1
						2.0 - 2.9	rond	0.1
						3.0 - 4.0	rond	0.1
						4.5 - 8.0	rond	0.5
369 E	24.13	32.15	101.6	8° 30'	11.1 x 1/20"	2.0 - 2.5	rond	0.5
						3.0 - 22.0	rond	0.5

# Pinces de serrage d'outils

Série 4

Type ER

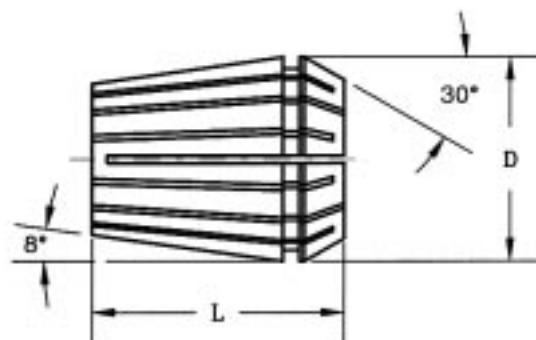

Référence	Type	D	L	Cône $\alpha$	Alésages		
					de - à ( mm )		par ( mm )
4260 E	ER 8	8.5	13.5	8°	0.5 - 2.5 3.0 - 5.0	rond rond	0.5 0.5
4009 E	ER 11	11.5	18	8°	1.0 - 2.5 3.0 - 7.0	rond rond	0.5 0.5
426 E	ER 16	17	27	8°	0.5 - 1.0 1.0 - 2.0 3.0 - 10.0	rond rond rond	. . 1.0
428 E	ER 20	21	31	8°	0.5 - 1.0 1.0 - 2.0 3.0 - 13.0	rond rond rond	. . 1.0
430 E	ER 25	26	35	8°	0.5 - 1.0 1.0 - 2.0 3.0 - 16.0	rond rond rond	. . 1.0
470 E	ER 32	33	40	8°	1.0 - 2.0 3.0 - 20.0	rond rond	. 1.0
472 E	ER 40	41	46	8°	3.0 . 4.0 - 30.0	rond rond	- 1.0
4769 E	ER 50	52	60	8°	6.0 - 10.0 12.0 - 34.0	rond rond	1.0 1.0
494 R	ER 60				12.0 - 40.0	rond	2.0
495 R	ER 90				20.0 - 52.0	rond	2.0

# Pinces de serrage d'outils

Série 4

Type Double Angle

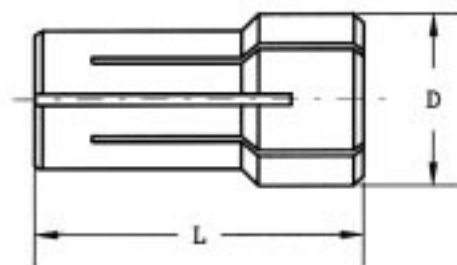

Référence	Type	d	D	L	Alésages		
					de - à ( mm )		par ( mm )
416 E	Série 30	7.62	9.5	25.5	1.0 - 1.5 2.0 . 2.5 . 3.0 - 6.5	rond rond rond rond	. . . 0.5
417 E	Série 20	11.43	13.6	30.4	1.0 - 1.5 2.0 . 2.5 . 3.0 - 9.5	rond rond rond rond	. . . 0.5
418 E	Série 10	16.51	19.47	36.7	1.0 - 2.5 3.0 - 5.5 6.0 - 14.5	rond rond rond	0.5 0.5 0.5
419 E	Série 18	22.08	26.04	41.7	2.0 . 2.5 - 5.5 6.0 - 20.0	rond rond rond	. 0.5 0.5
465 E	Série 40	30.6	36.9	50.8	4.0 - 12.0 12.5 - 25.5	rond rond	0.5 0.5

# Pinces de serrage tirées

Pour Têtes Multibroches



Série 6

Type W

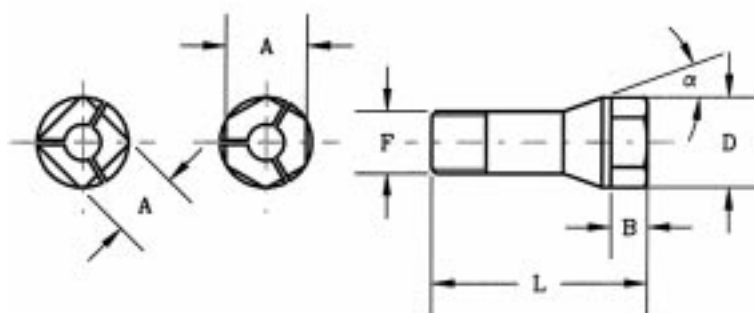

Référence	d	D	L	Cône $\alpha$	F	A	Alésages		
							de - à ( mm )		par ( mm )
6003 E	3	4.3	20	20°	M 3	3.3	1.0 - 1.5	rond rond	. 0.1
6023 E	5	6.5	20	20°	M 5 x 0.6	5.5	1.0 - 3.0	rond rond rond	. 0.1 .
600 E	6	9	28.5	10°	M 6 x 0.75	7	1.0 - 3.0	rond rond rond	. 0.1 0.1
6043 E	6	8.5	25.5	20°	M 6 x 0.7	6.5	1.0 - 3.0	rond rond rond	. 0.1 0.1
601 E	8	11	33	10°	M 8 x 0.75	9	1.0 - 5.5	rond rond rond rond	0.1 0.1 0.1 0.5
603 E	8	11.5	30.5	20°	M 8 x 0.85	9	1.0 - 3.0	rond rond rond	. 0.1 0.1
6314 E	10	14	34	15°	M 10 x 0.75	11	1.0 - 3.0	rond rond rond	. 0.1 0.1
635 E	12	18	34	15°	M 12 x 0.75	14	1.0 - 9.0	rond rond rond rond	. 0.1 0.1 .
6386 E	16.2	22	53	15°	M 16 x 1	17	3.0 - 10.0	rond	0.5

# Pinces de serrage Multibore

Série 7

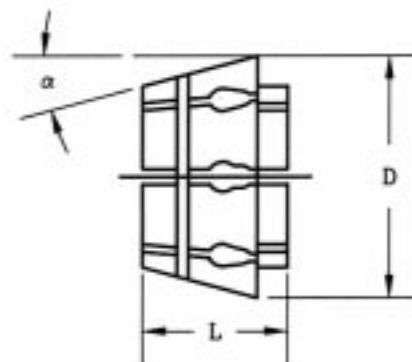

Référence	Type	D	L	Cône $\alpha$	Alésages		par ( mm )
					de - à ( mm )		
772 E	T 980	50.6	42.2	14°	1.58 - 28.57	rond	3.17
					1.58 - 25.40	6 pans	3.17
					1.58 - 19.05	4 pans	3.17
778 E	W 850	70.1	51.8	15°	1.58 - 41.27	rond	3.17
					1.58 - 25.40	6 pans	3.17
					25.40 - 38.10	6 pans	3.17
					1.58 - 25.40	4 pans	3.17
					25.40 - 31.75	4 pans	3.17
782 E	V 120	88.0	62.7	15°	1.58 - 53.97	rond	3.17
					3.17 - 25.40	6 pans	3.17
					25.40 - 44.45	6 pans	3.17
					44.45 - 50.80	6 pans	3.17
					3.17 - 25.40	4 pans	3.17
					25.40 - 41.27	4 pans	3.17
792 E	T 285	99.3	73.2	15°	3.17 - 66.67	rond	3.17
					3.17 - 25.40	6 pans	3.17
					25.40 - 44.45	6 pans	3.17
					44.45 - 57.15	6 pans	3.17
					3.17 - 25.40	4 pans	3.17
					25.40 - 44.45	4 pans	3.17
798 E	N 175	120.0	80.0	15°	12.0 - 78.0	rond	3.0
					77.0 - 80.0	rond	3.0
					12.0 - 24.0	6 pans	3.0
					24.0 - 45.0	6 pans	3.0
					45.0 - 69.0	6 pans	3.0
					15.0 - 24.0	4 pans	3.0
					24.0 - 45.0	4 pans	3.0
					45.0 - 54.0	4 pans	3.0

# Pinces de serrage Auto Multibore

Série 7

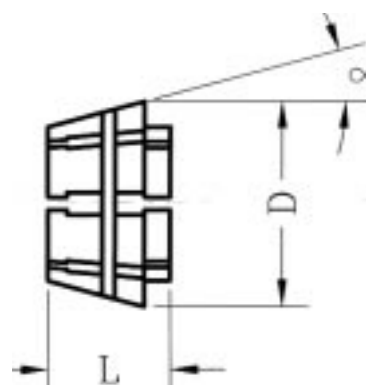

Référence	Type	D	L	Cône $\alpha$	Alésages		
					de - à ( mm )		par ( mm )
756 E	Série 12 M663	30.5	25.0	15°	3.0 - 16.0	rond	1.0
					3.0 - 14.0	6 pans	1.0
					3.0 - 11.0	4 pans	1.0
761 E	Série 18 M665	39.5	29	15°	4.0 - 22.0	rond	2.0
					4.0 - 18.0	6 pans	2.0
					4.0 - 14.0	4 pans	2.0
766 E	Série 20 M667	46.5	34	15°	4.0 - 26.0	rond	2.0
					4.0 - 22.0	6 pans	2.0
					4.0 - 18.0	4 pans	2.0
771 E	Série 24  M671	49.5	34	15°	4.0 - 30.0	rond	2.0
					4.0 - 26.0	6 pans	2.0
					4.0 - 24.0	4 pans	2.0
776 E	Série 36 M673	61.5	39	15°	4.0 - 42.0	rond	2.0
					4.0 - 26.0	6 pans	2.0
					26.0 - 36.0	6 pans	2.0
					4.0 - 26.0	4 pans	2.0
					26.0 - 30.0	4 pans	2.0
781 E	Série 52 M677	85.5	45	15°	6.0 - 60.0	rond	2.0
					6.0 - 26.0	6 pans	2.0
					26.0 - 44.0	6 pans	2.0
					44.0 - 60.0	6 pans	2.0
					6.0 - 26.0	4 pans	2.0
					26.0 - 42.0	4 pans	2.0

# Pinces de serrage Double Cône

Série 8

Type C

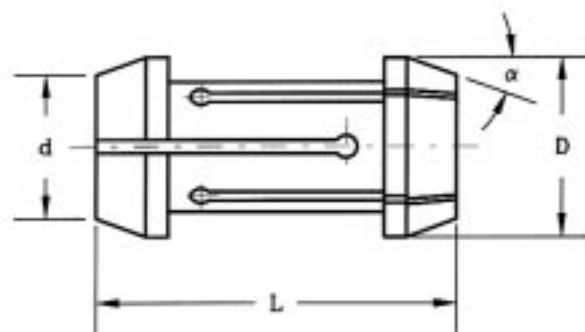

Référence	d	D	L	Cône $\alpha$	Alésages		
					de - à ( mm )		par ( mm )
8545 E	19	14	36	20°	5.0 - 12.0	rond	0.5
					5.0 - 10.0	6 pans	1.0
					5.0 - 8.0	4 pans	1.0
8639 E	26	21	50	14°	5.0 - 16.0	rond	0.5
					5.0 - 14.0	6 pans	1.0
					5.0 - 10.0	4 pans	1.0
8686 E	31	24	55	14°	8.0 - 20.0	rond	0.5
					8.0 - 17.0	6 pans	1.0
					8.0 - 14.0	4 pans	1.0
8689 E	32	26	68	14° 30'	7.0 - 20.0	rond	0.5
					7.0 - 17.0	6 pans	1.0
					7.0 - 14.0	4 pans	1.0
869 E	35	28	85	17° 30'	8.0 - 26.0	rond	0.5
					8.0 - 22.0	6 pans	1.0
					8.0 - 18.0	4 pans	1.0
8692 E	33	25	70	20°	7.0 - 22.0	rond	0.5
					7.0 - 20.0	6 pans	1.0
					7.0 - 16.0	4 pans	1.0
8789 E	40	30	75	20°	7.0 - 26.0	rond	0.5
					7.0 - 23.0	6 pans	1.0
					7.0 - 18.0	4 pans	1.0
8810 E	43	35	68	14°	10.0 - 32.0	rond	0.5
					10.0 - 25.0	6 pans	1.0
					10.0 - 20.0	4 pans	1.0
8890 E	59.4	46.9	120	20°	10.0 - 42.0	rond	1.0
					10.0 - 32.0	6 pans	1.0
					33.0 - 36.0	6 pans	1.0
					10.0 - 30.0	4 pans	1.0
8925 E	83	69	130	18°	40.0 - 65.0	rond	1.0
					41.0 - 50.0	6 pans	1.0
					51.0 - 57.0	6 pans	1.0



# Pinces Multibroches



**CHATEL  
GALLAY**

**PINCES  
MULTIBROCHES**

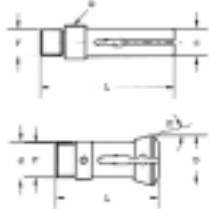

**Pour tours  
GILDEMEISTER**

page 1

**PINCES  
MULTIBROCHES**

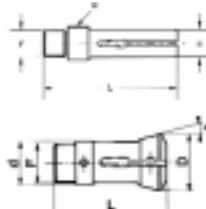

**Pour tours  
INDEX**

page 2

**PINCES  
MULTIBROCHES**

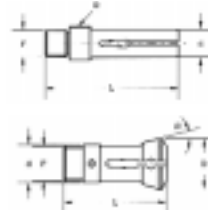

**Pour tours  
SCHÜTTLE**

page 3

**PINCES  
MULTIBROCHES**

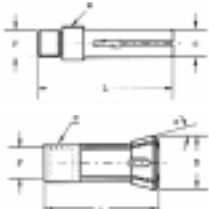

**Pour tours  
TORNOS**

page 4

**PINCES  
MULTIBROCHES**

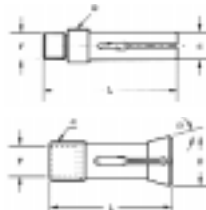

**Pour tours  
WICKMANN**

page 5

**PINCES  
MULTIBROCHES**

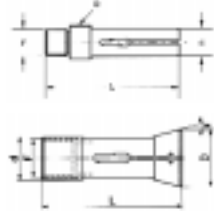

**Pour tours  
NEW BRITAIN**

Nous consulter

**PINCES  
MULTIBROCHES**

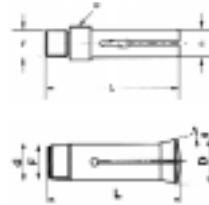

**Pour tours  
DAVENPORT**

Nous consulter

**PINCES  
MULTIBROCHES**

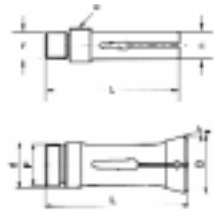

**Pour tours  
GRIDLEY**

Nous consulter

**PINCES  
MULTIBROCHES**

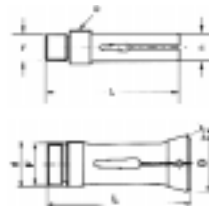

**Pour tours  
PITTLER**

Nous consulter

# Pinces de serrage et d'avance pour tours multibroches Gildemeister

Série 9

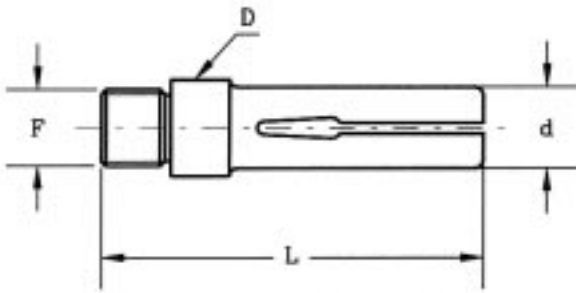

Fig. 1

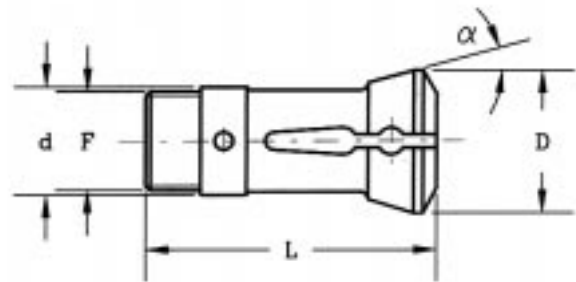

Fig. 2

Référence	d	D	L	Cône α	F	Fig	Alésages		
							de - à (mm)		par (mm)
9012 E	34	42	90	16°	M 30 x 1 G	2	8.0 - 20.0	rond	0.5
9258 E (Gildemeister AS 16 - AS 20)		25	90	.	M 24 x 1	1	8.0 - 17.0	6 pans	0.5
							8.0 - 20.0	rond	0.5
							8.0 - 17.0	6 pans	0.5

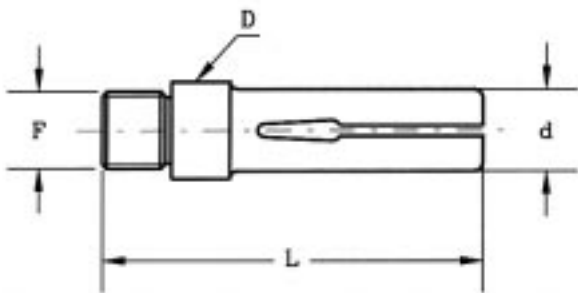

Fig. 1

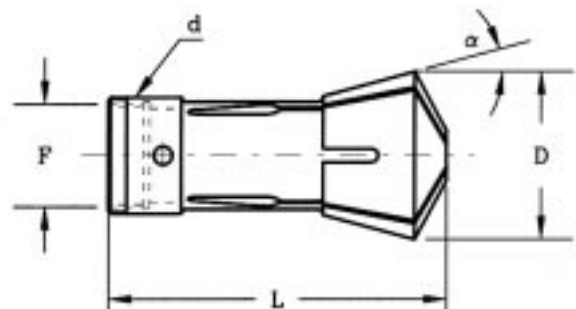

Fig. 2

Référence	d	D	L	Cône α	F	Fig	Alésages		
							de - à (mm)		par (mm)
9045 E	45	60.4	167	15°	M 40 x 1 G	2	15.0 - 25.0	rond	1.0
9287 E (Gildemeister AS 25)	.	33	140	.	M 30 x 1 G	1	15.0 - 25.0	rond	1.0
9069 E	53	69.4	129	15°	M 65 x 1.5 G	2	10.0 - 32.0	rond	1.0
9316 E (Gildemeister AS 32 - AV 32)		40	136	.	M 38 x 1.5 G	1	14.0 - 27.0	6 pans	1.0
(Gildemeister GM 32)		41.2			M 39 x 1.0 D/G	1	10.0 - 32.0	rond	1.0
(Gildemeister GM 32)		41.2			M 38 x 1.5 D/G	1	14.0 - 27.0	6 pans	1.0
(Gildemeister GM 35)		41.2			M 38 x 1.5 D/G	1			
9132 E	70	90.4	150	15°	M 65 x 1.5 G	2	20.0 - 48.0	rond	1.0
							20.0 - 32.0	6 pans	1.0
9368 E (Gildemeister AS - AV - AA - AR 48)	.	57	160	.	M 54 x 1.5 G	1	33.0 - 40.0	6 pans	1.0
							20.0 - 48.0	rond	1.0
							20.0 - 32.0	6 pans	1.0
							33.0 - 40.0	6 pans	1.0
9178 E	90	115.4	171	15°	M 85 x 1.5 G	2	30.0 - 67.0	rond	1.0
9447 E (Gildemeister AS 67)	.	77.5	170	.	M 74 x 1.5 G	1	30.0 - 67.0	rond	1.0

# Pinces de serrage et d'avance pour tours multibroches Index

Série 9

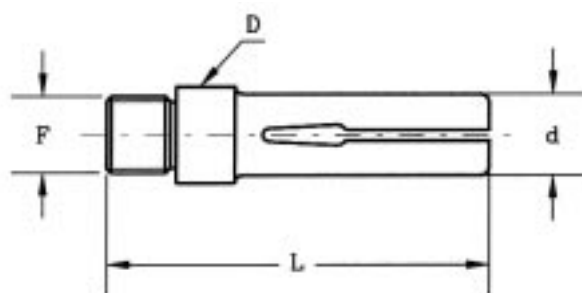

Fig. 1

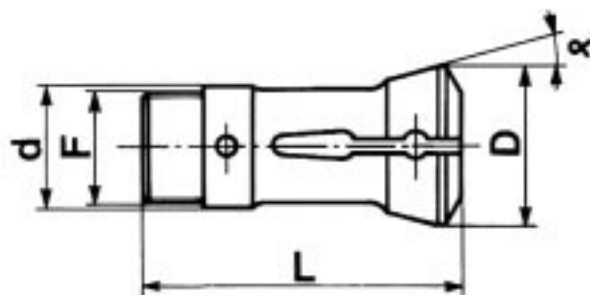

Fig. 2

Référence	d	D	L	Cône $\alpha$	F	Fig	Alésages (mm)		par (mm)
9007 E	32	41.5	84	15°	M 28 x 1 G	2	7.0 - 16.0	rond	1.0
9255 E (Index MS 136)	23	25	88		M 23 x 1	1	7.0 - 16.0 7.0 - 14.0	rond 6 pans	1.0 1.0
9033 E	40	55.2	102	15°	M 35 x 1.5 G	2		rond	
9273 E (Index KS 20)		30.8	102		M 28 x 1.5 G	1		6 pans rond 6 pans	
9039 E	46	60.3	112	15°	M 40 x 1.5 G	2	10.0 - 26.0	rond	1.0
9282 E (Index KS - MS 25)		37	118		M 33 x 1.5 G	1	10.0 - 22.0 10.0 - 26.0	6 pans rond	1.0 1.0
9070 E	53	69.3	128	15°	M 47 x 1.5 G	2	15.0 - 32.0	rond	1.0
9319 E (Index KS 32)	40	43	130		M 38 x 1.5	1	15.0 - 28.0 15.0 - 32.0	6 pans rond	1.0 1.0
9108 E	62	82.4	180	15°	M 58 x 1.5 G	2	20.0 - 40.0	rond	1.0
9364 E (Index KS 42)	50	54	170		M 50 x 1.5 G	1	20.0 - 40.0	rond	1.0
9133 E	70	92	156	15°	M 65 x 2 G	2	20.0 - 50.0	rond	1.0
9402 E (Index KS 50)	57	60	156		M 57 x 2 G	1	20.0 - 50.0	rond	1.0

# Pinces de serrage et d'avance pour tours multibroches Schütte

Série 9

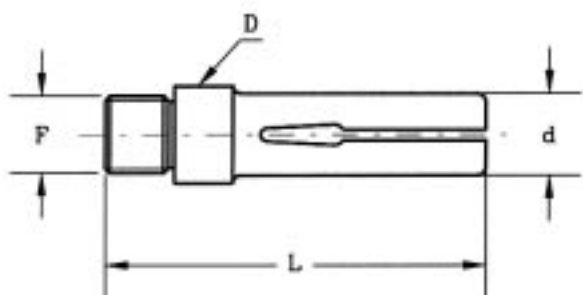

Fig. 1

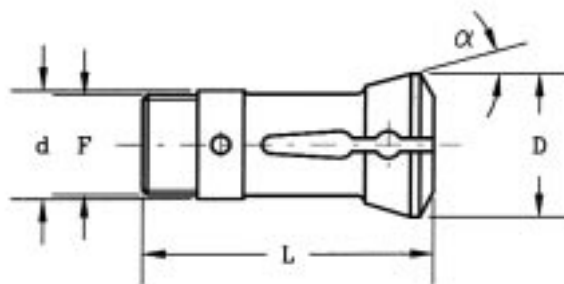

Fig. 2

Référence	d	D	L	Cône α	F	Fig	Alésages		
							de - à (mm)		par (mm)
9015 E	25	34	83.5	15°	24 x 1 .	2	6.0 - 13.0	rond	1.0
9261 E (Schütte SF 12 -SF 13)		19.6					82	17 x 1 .	1
							6.0 - 10.0	6 pans	1.0
9007 E	32	41.5	84	15°	28 x 1 G	2	7.0 - 16.0	rond	1.0
9255 E (Schütte SE 16 - SE 18)		25					88	23 x 1 G	1
							7.0 - 14.0	6 pans	1.0
9049 E	46	60.3	120	15°	40 x 1.5 G	2	10.0 - 26.0	rond	1.0
9282 E (Schütte SD 25 - SE 25 VD 25 - SE 26)		35					118	33 x 1.5 .	1
							10.0 - 22.0	6 pans	1.0
9070 E	53	69.3	136	15°	47 x 1.5 G	2	15.0 - 32.0	rond	1.0
9319 E (Schütte SD - SF - VD 32)		43					130	38 x 1.5 .	1
							15.0 - 28.0	6 pans	1.0
9112 E	62.9	78.3	157	15°	56 x 1.5 G	2	20.0 - 40.0	rond	1.0
9372 E (Schütte AD - SF 40 - SF 42)		51					161.5	48 x 1.5 .	1
9139 E	75	97.8	187	15°	68 x 1.5 G	2	20.0 - 50.0	rond	1.0
9406 E (Schütte SD - SF 50 - SF 51)		62					195	58 x 1.5 .	1

# Pinces de serrage et d'avance pour tours multibroches Tornos

Série 9

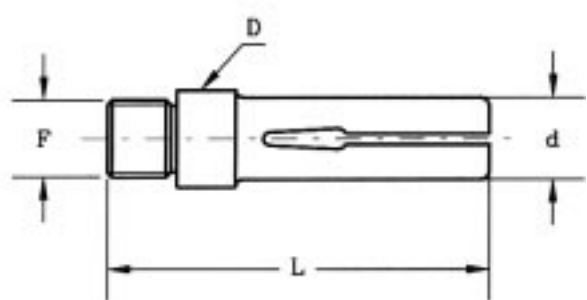

Fig. 1

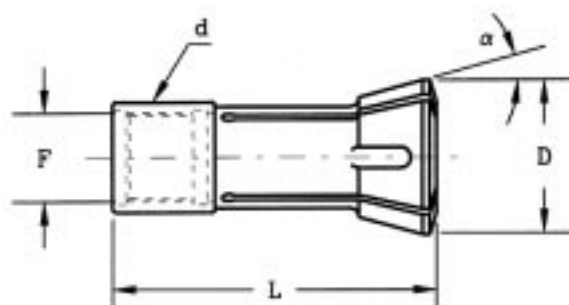

Fig. 2

Référence	d	D	L	Cône $\alpha$	F	Fig	Alésages		
							de - à (mm)		par (mm)
9001 E	25	35	75	16°	M 22 x 1	2	4.0 - 14.0	rond	0.5
							5.0 - 12.0	6&4pans	1.0
9251 E (Tornos AS 14)	17.5	17.9	70		M 16 x 0.75	1	4.0 - 14.0	rond	0.5
							5.0 - 12.0	6&4pans	1.0

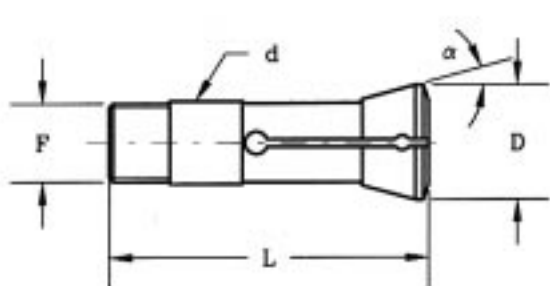

Fig. 3

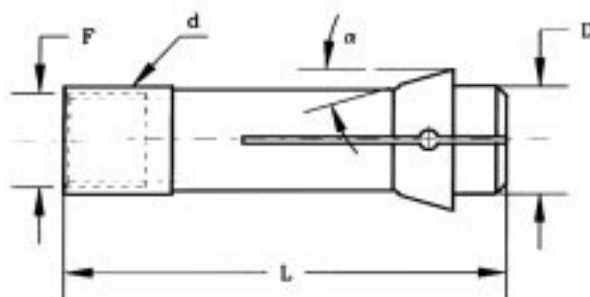

Fig. 4

Référence	d	D	L	Cône $\alpha$	F	Fig	Alésages		
							de - à (mm)		par (mm)
9001 RE	25	35	94	15° 30'	M 25 x 1.00	3	8.0 - 16.0	rond	0.5
							8.0 - 14.0	6&4pans	1.0
9251 RE (Tornos AS 16)	20.5	22.8	98		M 20 x 0.75	1	8.0 - 16.0	rond	0.5
							8.0 - 14.0	6&4pans	1.0
9018 E	35	45	107	15° 30'	M 33 x 1	3	8.0 - 22.0	rond	1.0
							8.0 - 19.0	6&4pans	1.0
9263 E (Tornos BS 22/8)		29.7	116		M 27 x 1	1	8.0 - 22.0	rond	1.0
							8.0 - 19.0	6&4pans	1.0
3263 E (Pince contre-broche)	16		66	16°	14 x 7.5	4	3.0 - 13.0	rond	0.1
9031 E	36	45	107	15°30'	M 33 x 1.25	2	8.0 - 20.0	rond	1.0
							8.0 - 18.0	6&4pans	1.0
9264 E (Tornos BS 20)	27.7				M 25 x 1	1	8.0 - 20.0	rond	1.0
							8.0 - 18.0	6&4pans	1.0

# Pinces de serrage et d'avance pour tours multibroches Wickman

Série 9

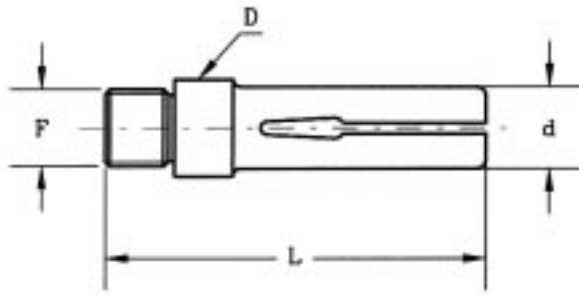

Fig. 1

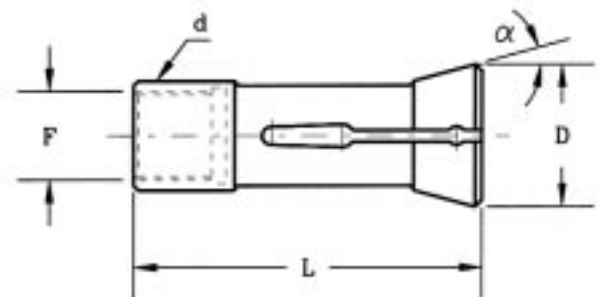

Fig. 2

Référence	d	D	L	Cône α	F	Fig	Alésages		
							de - à ( mm )		par ( mm )
9014 E	29.4	38.15	92.2	15° 15'	26.2 x 24 F' G	2	7.0 - 16.0	rond	1.0
							7.0 - 14.0	6 pans	1.0
							Serrage mère		
9260 E (Wickman 5/8")	20.8	21.6	57.7		19.0 x 24 F' G	1	7.0 - 16.0	rond	1.0
							7.0 - 14.00	6 pans	1.0
							Avance mère		
9034 E	41.3	54.5	131.7	15°	37.7 x 24 F' G	2	8.0 - 26.0	rond	1.0
							8.0 - 23.0	6 pans	1.0
							Serrage mère		
9276 E (Wickmann 1")	30.9	31.9	133.3		30.1 x 24 F' G	1	8.0 - 26.0	rond	1.0
							8.0 - 23.0	6 pans	1.0
							Avance mère		
9072 E	55.47	66.8	117.5	15°	50.8 x 22 F' G	2	15.0 - 35.0	rond	1.0
							15.0 - 32.0	6 pans	1.0
							Serrage mère		
9318 E (Wickmann 1" 3/8)	42.7	42.84	117.5		40.5 x 22 F' G	1	15.0 - 35.0	rond	1.0
							15.0 - 32.0	6 pans	1.0
							Avance mère		
9111 E	64.21	78.7	127	15°	60.3 x 16 F' G	2	20.0 - 45.0	rond	1.0
							20.0 - 26.0	6 pans	1.0
							27.0 - 40.0	6 pans	1.0
							Serrage mère		
9362 E (Wickman 1 3/4")	51.6	52.37	127		50.0 x 22 F' G	1	20.0 - 45.0	rond	1.0
							20.0 - 26.0	6 pans	1.0
							27.0 - 40.0	6 pans	1.0
							Avance mère		
9145 E	76.86	95.5	180.9	15°	72.5 x 22 F' G	2	30.0 - 58.0	rond	1.0
							30.0 - 50.0	6 pans	1.0
							Serrage mère		
9409 E (Wickman 2 1/4")	64.3	64.3	171.5		62.7 x 22 F' G	1	30.0 - 58.0	rond	1.0
							30.0 - 50.0	6 pans	1.0
							Avance mère		
9281 E	92.07	111.1	165.1	15° 15'	85.9 x 18 F' .	2	30.0 - 64.0	rond	1.0
							Serrage mère		
9445 E (Wickman 2 5/8")	74.6	75.6	177.8		73.0 x 24 F' G	1	30.0 - 64.0	rond	1.0
							Avance mère		