

Portes-Pinces



PORTE-PINCES REGLABLES & VDI



MANDRINS FLOTTANTS



PORTE-OUTILS



PORTE-FRAISES

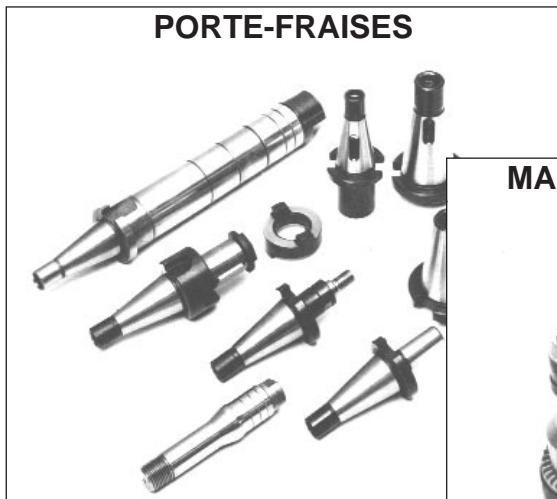

MANDRINS DE PERCEUSES



POINTES DE TOURS



ALLONGES & DOUILLES DE REDUCTION



Porte - Pincés Mini



Référence	Désignation	Pincés	D	L	Capacité
C1414 0707	CYL7X45	ER11	16	26	7
C1414 0807	CYL8X45	ER11	16	26	7
C1414 1010	CYL10X60	ER16	22	37	10
C1414 1210	CYL12X80	ER16	22	37	10
C1414 1410	CYL14X30	ER16	22	37	10
C1415 1410	CYL14X60	ER16	22	37	10
C1414 1610	CYL16X34	ER16	22	37	10
C1415 1610	CYL16X60	ER16	22	37	10
C1414 2010	CYL20X60	ER16	22	37	10
C1416 2010	CYL20X140	ER16	22	32	10
C1415 2013	CYL20X46	ER20	28	38	13
C1416 2013	CYL20X60	ER20	28	30	13

Porte - Pincés Cylindrique

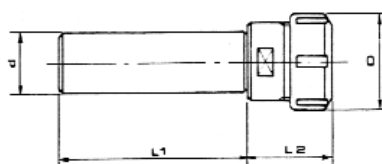

Référence	Désignation	Pincés	D	L	Capacité
C1411 1410	CYL14X30	ER16	28	36	10
C1412 1410	CYL14X60	ER16	28	36	10
C1411 1610	CYL16X34	ER16	28	36	10
C1412 1610	CYL16X60	ER16	28	36	10
C1411 1813	CYL18X46	ER20	34	36	13
C1411 2010	CYL20X50	ER16	28	30	10
C1412 2010	CYL20X100	ER16	28	30	10
C1411 2013	CYL20X30	ER20	34	36	13
C1412 2013	CYL20X46	ER20	34	36	13
C1413 2013	CYL20X60	ER20	34	36	13
C1411 2016	CYL20X46	ER25	42	46	16
C1413 2016	CYLX10	ER25	42	46	16
C1411 2020	CYL20X46	ER32	50	54	20
C1413 2020	CYL20X100	ER32	50	54	20
C1411 2516	CYL25X50	ER25	42	46	16
C1412 2516	CYL25X100	ER25	42	46	16
C1411 2520	CYL25X50	ER32	50	54	20
C1412 2526	CYL25X50	ER40	63	61	26
C1411 3016	CYL30X50	ER25	42	33	16
C1412 3020	CYL30X50	ER32	50	49	20
C1411 3220	CYL32X70	ER32	50	44	20
C1411 1910	CYL3/4"X100	ER16	28	30	10
C1411 1913	CYL3/4"X32	ER20	34	36	13
C1412 1913	CYL3/4"X46	ER20	34	36	13
C1411 1916	CYL3/4"X46	ER25	42	46	16
C1412 1916	CYL3/4"X100	ER25	42	46	16
C1411 2616	CYL1"X46	ER25	42	33	16
C1413 2616	CYL1"X100	ER25	42	33	16
C1411 2620	CYL1"X46	ER32	50	54	20
C1411 2626	CYL1"X50	ER40	63	61	26

Porte - Pincés Cône morse

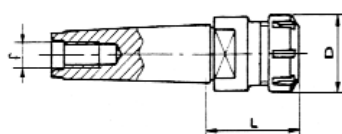

Référence	Désignation	Pincés	D	L	Capacité
C1211 0170	CM1	ER11	19	25	7
C1211 0110	CM1	ER16	28	37	10
C1211 0210	CM2	ER16	28	37	10
C1211 0213	CM2	ER20	34	43	13
C1211 0216	CM2	ER25	42	47	16
C1211 0316	CM3	ER25	42	53	16
C1211 0320	CM3	ER32	50	64	20
C1211 0326	CM3	ER40	63	80	26
C1211 0420	CM4	ER32	50	54	20
C1211 0426	CM4	ER40	63	75	26
C1211 0526	CM5	ER40	63	75	26
C1211 0534	CM5	ER50	78	84	34

Porte - Pincas Iso

DIN ISO 7388/3

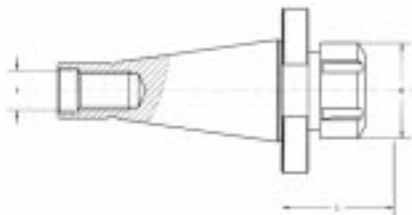

Référence	Désignation	Pincas	D	L	Capacité
C1111 3016	ISO30	ER25	42	42	16
C1111 3020	ISO30	ER32	50	51	20
C1114 3013	ISO30	ER20M	28	80	13
C1111 4016	ISO40	ER25	42	43	16
C1111 4020	ISO40	ER32	50	43	20
C1111 4026	ISO40	ER40	63	51	26
C1111 4034	ISO40	ER50	78	79	34
C1112 4020	ISO40	ER32	50	70	20
C1113 4020	ISO40	ER32	50	160	20
C1113 5020	ISO40	ER32	50	100	20
C1114 4013	ISO40	ER20M	28	90	13
C1111 5020	ISO50	ER32	50	68	20
C1111 5026	ISO50	ER40	63	59	26
C1111 5034	ISO50	ER50	78	67	34



Porte - Pincas BT

DIN MAS 403

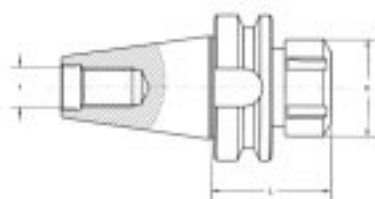

Référence	Désignation	Pincas	D	L	Capacité
C1711 3010	BT30	ER16	28	70	10
C1711 3016	BT30	ER25	42	60	16
C1711 3020	BT30	ER32	50	70	20
C1711 3510	BT35	ER16	28	70	10
C1711 3516	BT35	ER25	42	60	16
C1711 3520	BT35	ER32	50	70	20
C1711 4010	BT40	ER16	28	70	10
C1711 4013	BT40	ER20	34	70	13
C1711 4016	BT40	ER25	42	70	16
C1711 4020	BT40	ER32	50	60	20
C1711 4026	BT40	ER40	63	80	26
C1711 4034	BT40	ER50	78	85	34
C1711 4016	BT40	ER25	42	60	16
C1711 4020	BT40	ER32	50	75	20
C1711 4026	BT40	ER40	63	75	26
C1711 4520	BT45	ER32	50	85	20
C1711 4526	BT45	ER40	63	90	26
C1711 4534	BT45	ER50	78	90	34
C1711 5020	BT50	ER32	50	90	20
C1711 5026	BT50	ER40	63	95	26
C1711 5034	BT50	ER50	78	95	34



Porte - Pincas TC

DIN 69871/A - ISO 7388/1

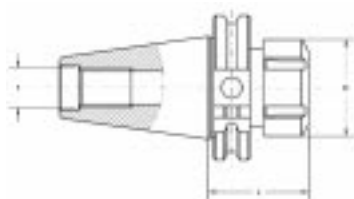

Référence	Désignation	Pincas	D	L	Capacité
C1611 4020	TC40X60	ER32	50	60	20
C1612 4020	TC40X100	ER32	50	100	20
C1611 4026	TC40X80	ER40	63	80	26
C1612 4026	TC40X120	ER40	63	120	26
C1611 4520	TC45X80	ER32	50	80	20
C1612 4520	TC45X120	ER32	50	120	20
C1611 4526	TC45X80	ER40	50	80	26
C1611 4534	TC45X80	ER50	78	80	34
C1612 4534	TC45X120	ER50	78	120	34
C1612 5020	TC50X160	ER32	50	160	20
C1611 5026	TC50X100	ER40	63	100	26
C1612 5034	TC50X160	ER50	78	160	34



Tirettes

DIN 69872/ISO 7388 A/B

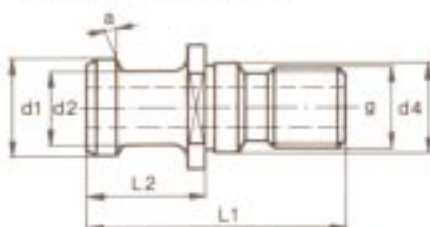

ANSI B 5.50

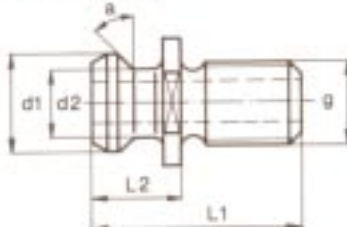

MAS BT

